

9 CONNECTIONS AND INSTALLATION

■ Connections

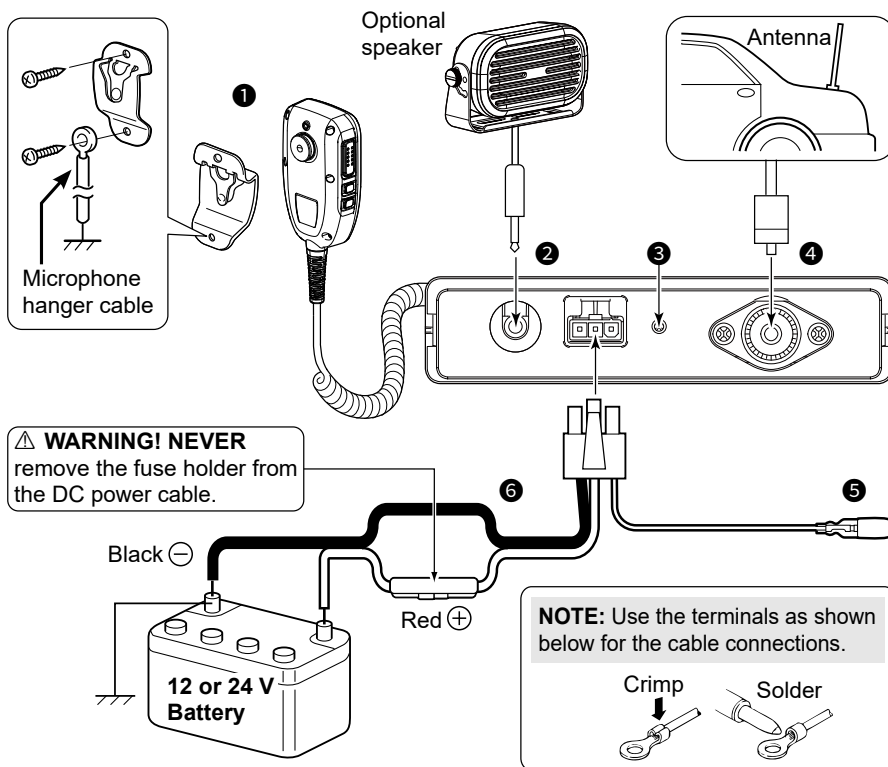

① MICROPHONE HANGER

Connects to the supplied microphone hanger to a vehicle's ground to use the Mic Hanger function. (p. 29)

② EXTERNAL SPEAKER JACK

Connects to a 4 Ω external speaker.

① The audio output power is typically 5 W.

③ GROUND TERMINAL

Connects to a vehicle's ground to prevent electrical shocks and interference from other equipment occurring.

Use a screw (3 × 12 mm: not supplied).

④ ANTENNA CONNECTOR

Connects to an antenna with a PL-259 connector.

A key element in the performance of any communication system is the antenna. Ask your dealer about antennas and the best place to mount them.

CAUTION: DO NOT transmit without an antenna.

5 IGNITION LEAD

Connects to an ignition line.

To turn the transceiver ON or OFF when you turn the car key or push the ignition switch, connect the transceiver's ignition lead to where the 12 V or 24 V is output from the ACC terminal, and 0 V on the OFF/LOCK terminal.

① You must turn ON the Ignition Sense function. (p. 30)

NOTE:

- **DO NOT** put pressure on this lead.
- When you do not need to connect this line, be sure to keep the lead cap on for safety.

6 POWER RECEPTACLE

Connecting to a DC power source:

Connects to a 12 V or 24 V DC power source with the supplied DC power cable.

Red (+), Black (-)

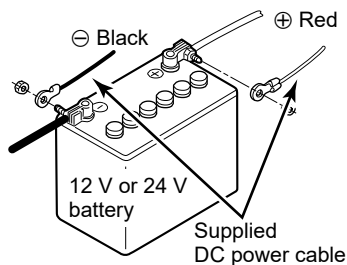

9

NOTE: DO NOT use the cigarette lighter socket as a power source when operating in a vehicle. The plug may cause voltage drops, and ignition noise may be superimposed onto the transmit or receive audio. Install a rubber grommet before passing the DC power cable through a metal plate to prevent a short circuit.

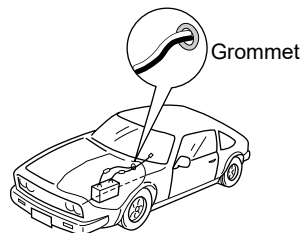

Connecting to a DC power supply:

Connects to a 13.8 V or 27.6 V DC power supply with at least 3 A capacity with the supplied DC power cable. Red (+), Black (-)

Make sure the ground terminal of the DC power supply is grounded.

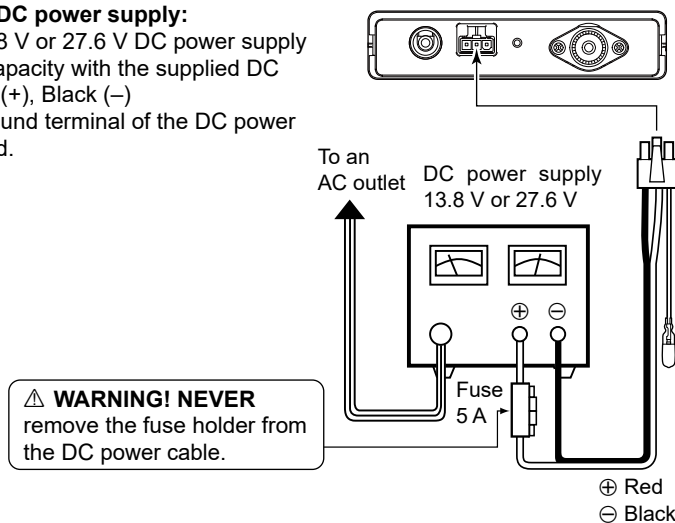

WARNING! NEVER remove the fuse holder from the DC power cable.

⊕ Red
⊖ Black